

AERODROME CHART - ICAO

50°04'40" N
019°47'05" E

ELEV 241 m
GEOID UND. 40 m

TWR 123.250
GROUND 118.100

KRAKÓW / Balice

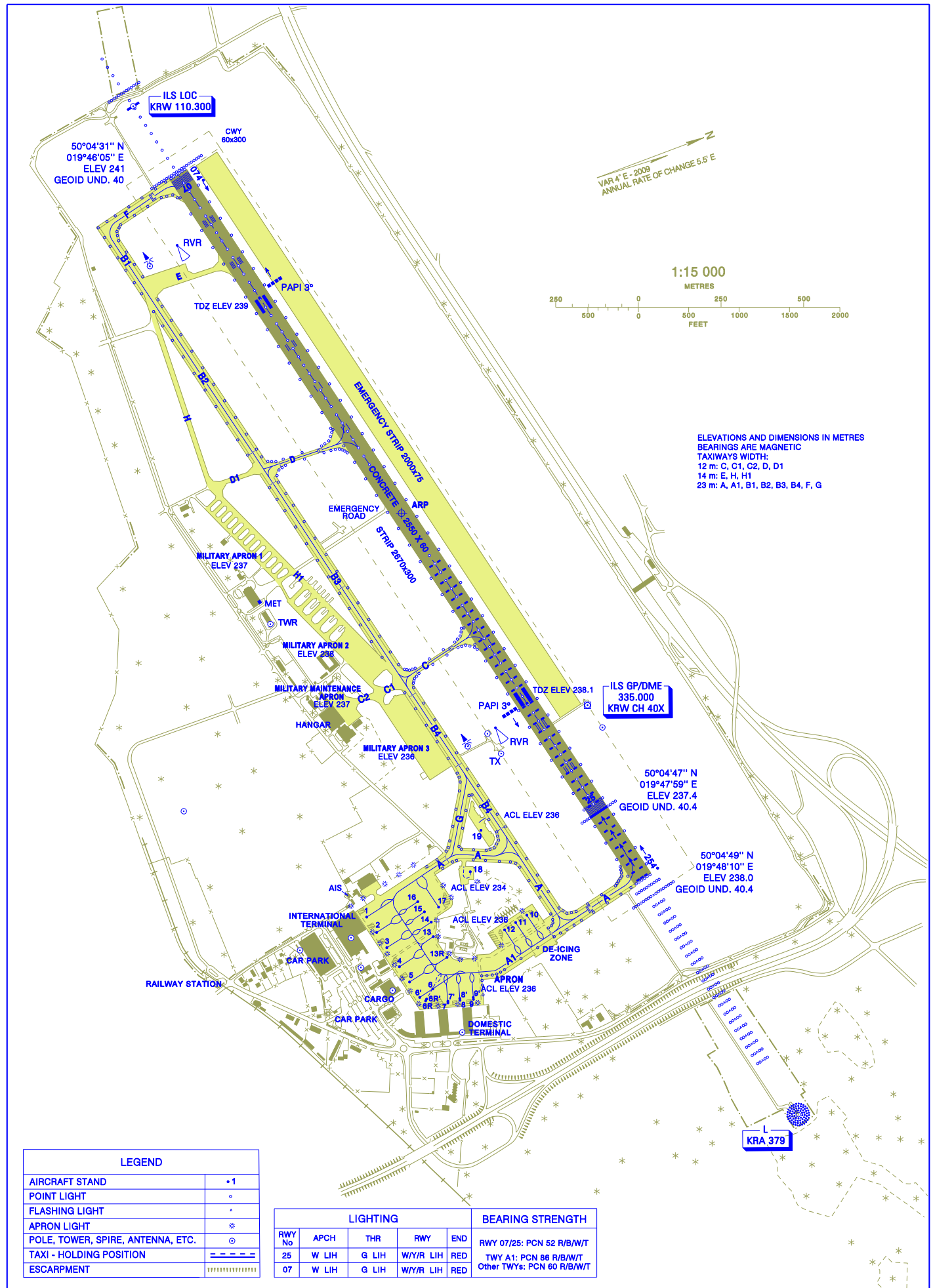

ELEVATIONS AND DIMENSIONS IN METRES
BEARINGS ARE MAGNETIC
TAXIWAYS WIDTH:
12 m: C, C1, C2, D, D1
14 m: E, H, H1
23 m: A, A1, B1, B2, B3, B4, F, G

LEGEND	
AIRCRAFT STAND	• 1
POINT LIGHT	◦
FLASHING LIGHT	△
APRON LIGHT	*
POLE, TOWER, SPIRE, ANTENNA, ETC.	⊙
TAXI - HOLDING POSITION	≡≡≡≡≡
ESCARPMENT	

LIGHTING					BEARING STRENGTH	
RWY No	APCH	THR	RWY	END		
25	W LIH	G LIH	WY/R LIH	RED	RWY 07/25: PCN 52 R/B/W/T	
07	W LIH	G LIH	WY/R LIH	RED	TWY A1: PCN 86 R/B/W/T Other TWYs: PCN 60 R/B/W/T	

Zam. 4390 nakł. 600 egz. Date of survey 20.04.2011